

4

3

2

1

ITEM NO.	PART NUMBER	DESCRIPTION	QTY.
1	JT6301-1.A	DVR Truss Pad	1
2	JT6301-2.A	PSG Truss Pad	1
3	JT6301-3.A	DVR Coil Pad	1
4	JT6301-4.A	PSG Coil Pad	1
5	JT6301-5.A	DVR UPPER CTL ARM	1
6	JT6301-6.A	PSG UPPER CTL ARM	1
7	JT6301-7.A	TRACK BAR BKT OUTER	1
8	JT6301-8.A	TRACK BAR BKT INNER	1
9	JT6301-9.A	DVR LOWER CTL ARM	1
10	JT6301-10.A	PSG LOWER CTL ARM	1
11	JT6301-11.A	DVR SHOCK MNT	1
12	JT6301-12.A	PSG SHOCK MNT	1
13	JT6301-13.A	DVR SWAYBAR MNT	1
14	JT6301-14.A	PSG SWAYBAR MNT	1
15	TU2002.A	COIL TUBE	2
16	HW0043	3/8"-16 ZINC PRESS NUT	4

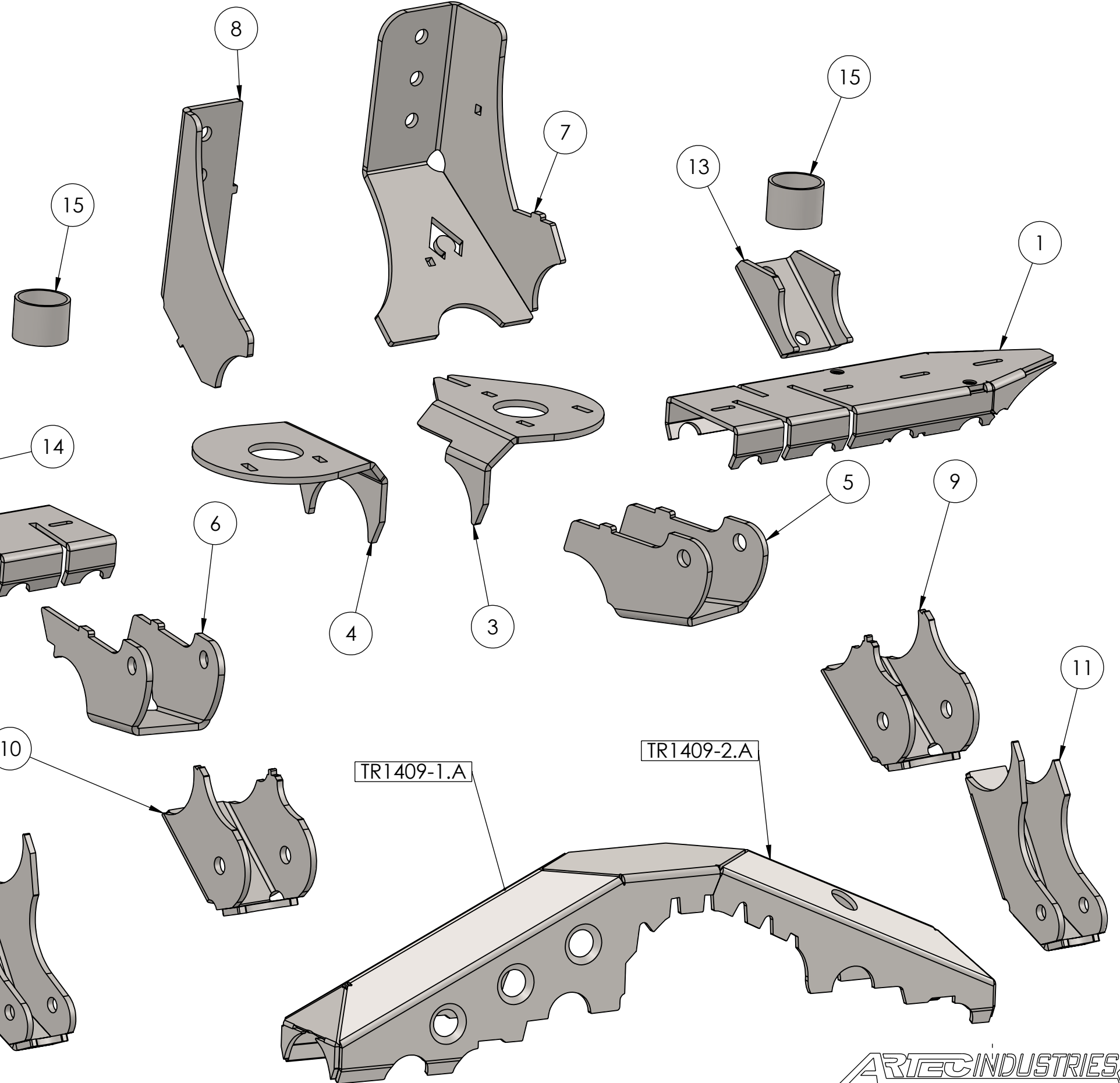

ITEM NO.	PART NUMBER	DESCRIPTION	QTY.
1	TR1409-1.A	PSG SIDE	1
2	TR1409-2.A	DVR SIDE	1

4

3

2

1

ARTEC INDUSTRIES

4

3

2

1

B

B

A

A

JT6301-8.A

TU2002.A

JT6301-14.A

JT6301-2.A

JT6301-4.A

JT6301-6.A

JT6301-10.A

JT6301-12.A

JT6301-7.A

JT6301-3.A

JT6301-5.A

TR1409-2.A

TR1409-1.A

TU2002.A

JT6301-13.A

JT6301-1.A

JT6301-9.A

JT6301-11.A

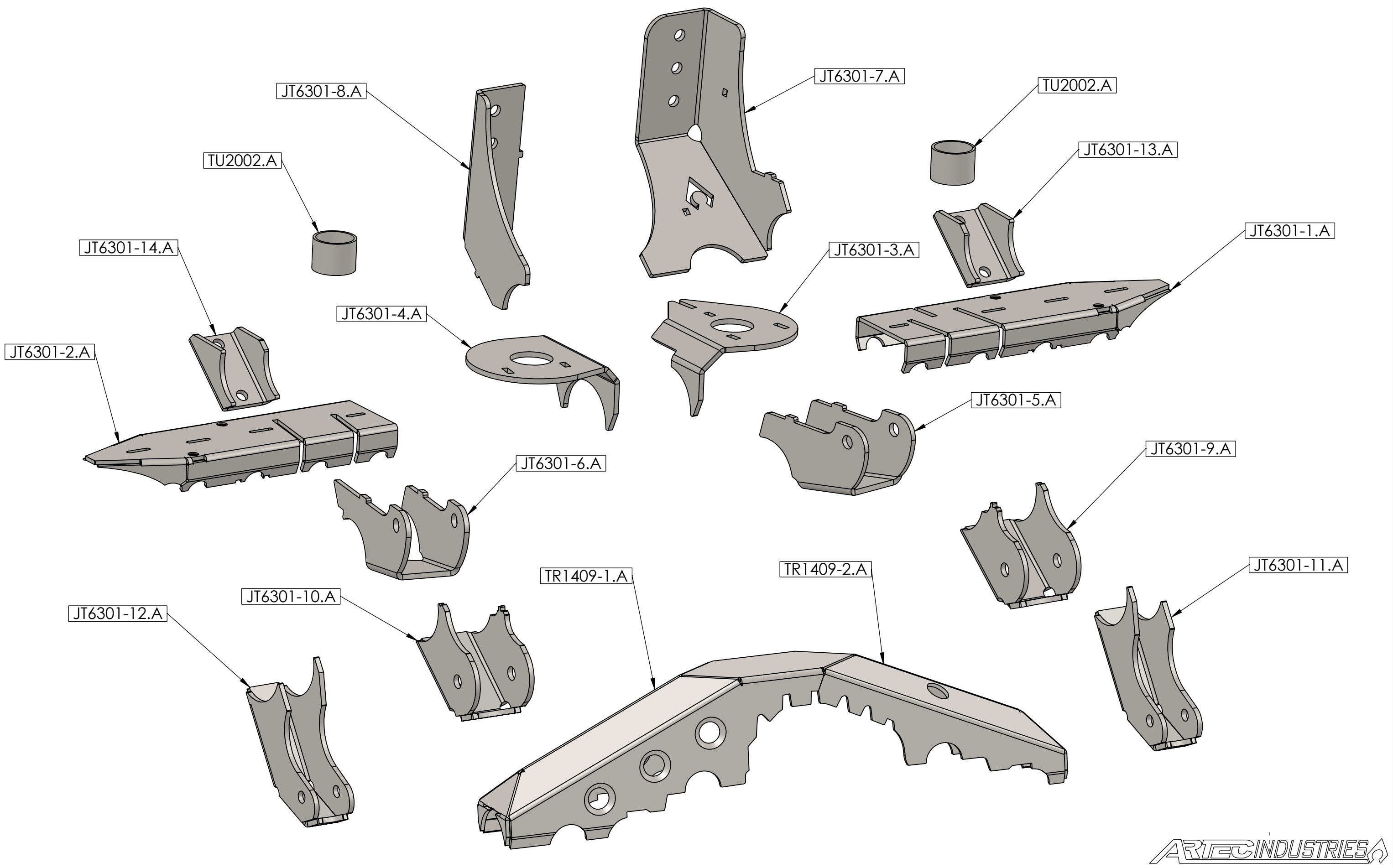

4

3

2

1

4

3

2

1

TRUSS: INSTALL & Weld TRUSS at a 5° Forward Angle from Diff Surface.

B

B

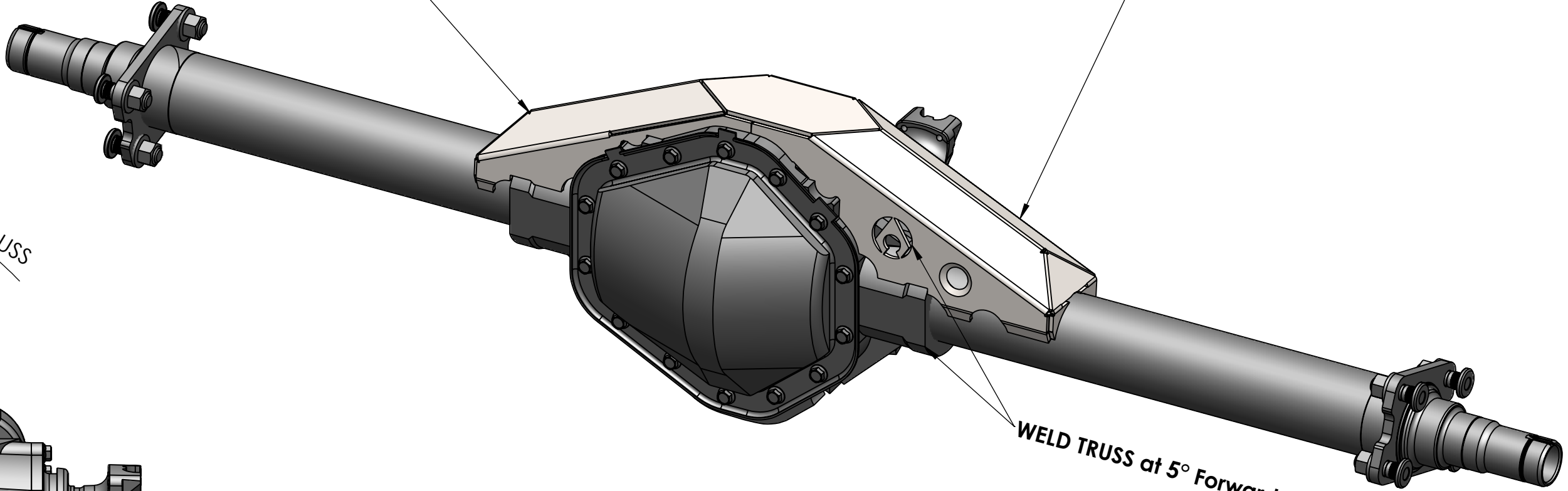
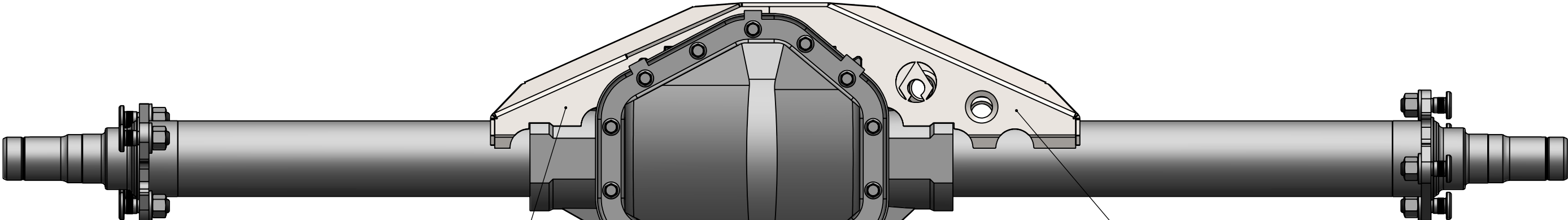

5° DIFF to TRUSS

A

A

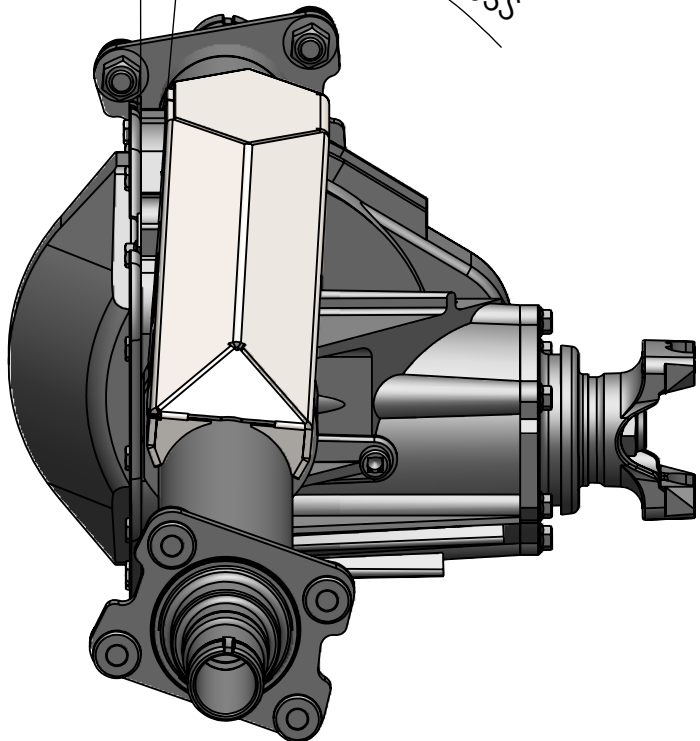

4

3

2

1

4

3

2

1

**STEP 1: KEY - INSTALL & WELD DVR & PSG TRUSS PAD at 82.5° From Top of Pad Diff Surface.**

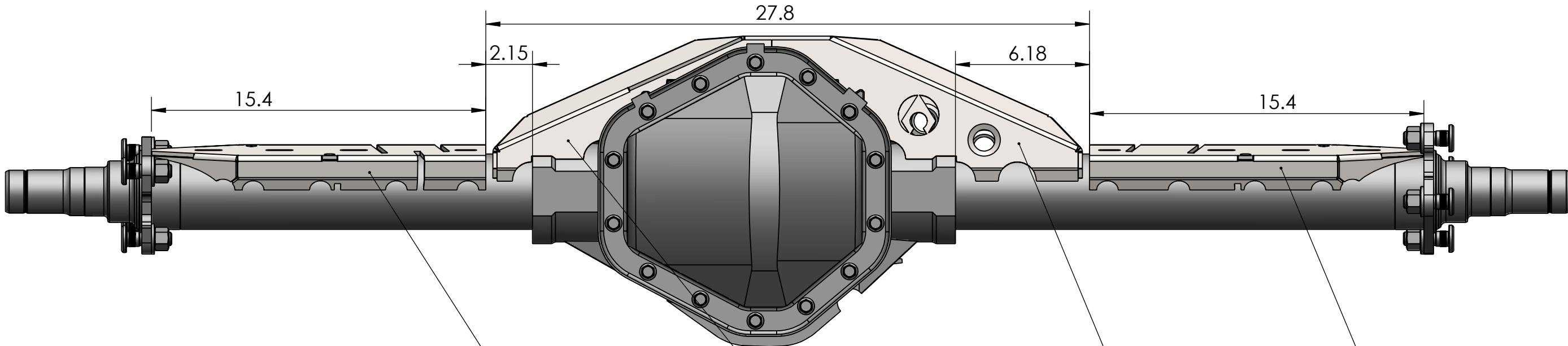

B

B

Key Truss Pad to Backing Plate Surface

**\*Clearancing Required around OE Weld\***

JT6301-1.A

TR1409-2.A

TR1409-1.A

JT6301-2.A

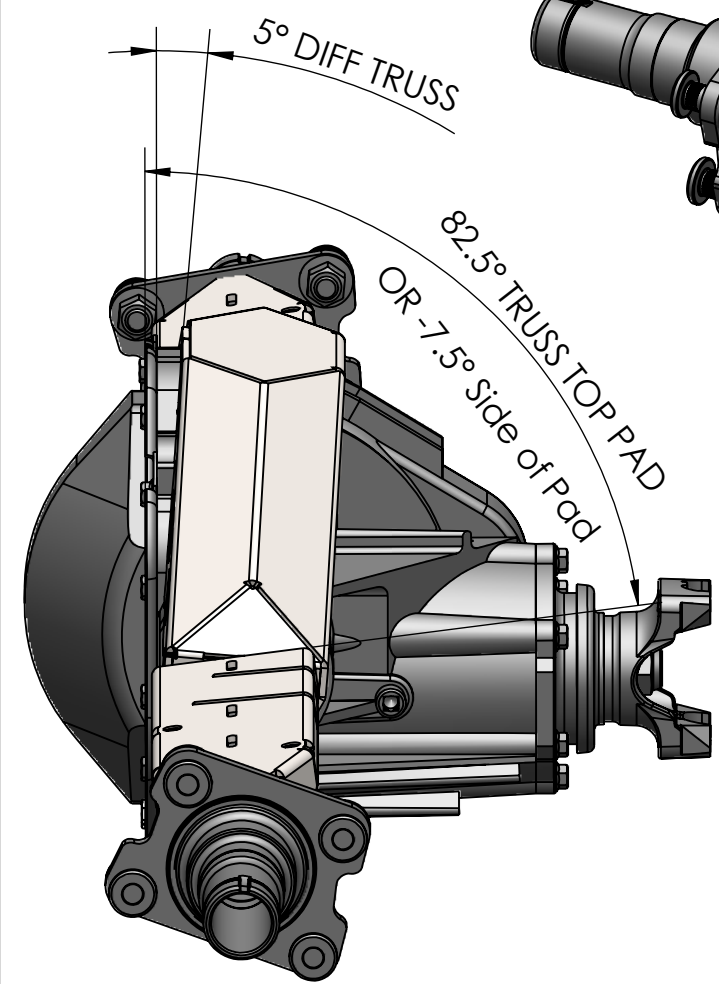

A

A

**\* Clearancing Required for Truss Pad Once Truss is Welded to Housing \***

Key Truss Pad to Backing Plate Surface

**\*Clearancing Required around OE Weld\***



4

3

2

1

4

3

2

1

STEP 2: KEY / INSTALL & WELD DVR & PSG Upper Control Arm Brackets to TRUSS PAD

A

B

PSG SIDE KEYED TO TRUSS PAD

B

B

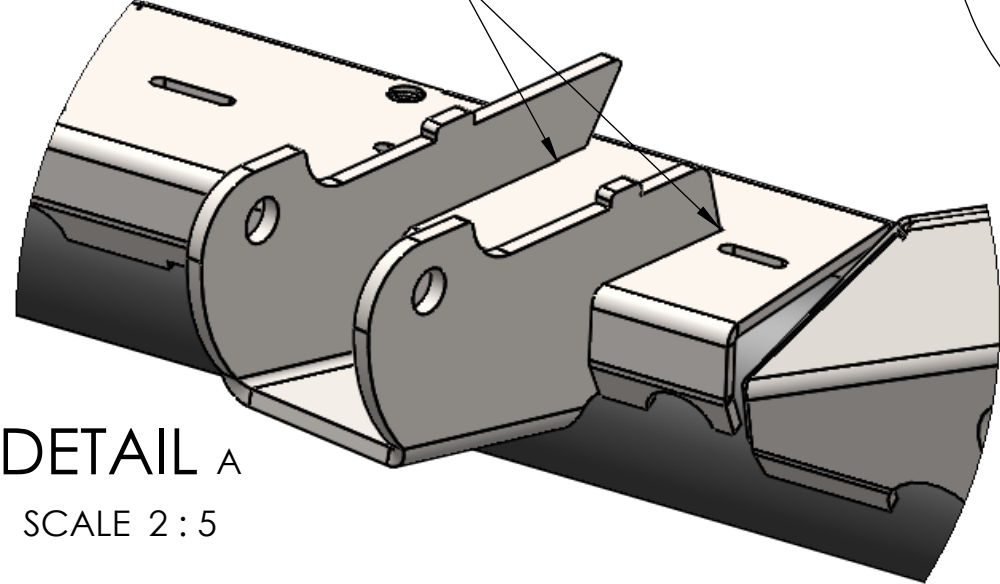

DETAIL A  
SCALE 2 : 5

JT6301-5.A

JT6301-6.A

DVR SIDE KEYED TO TRUSS PAD

A

A

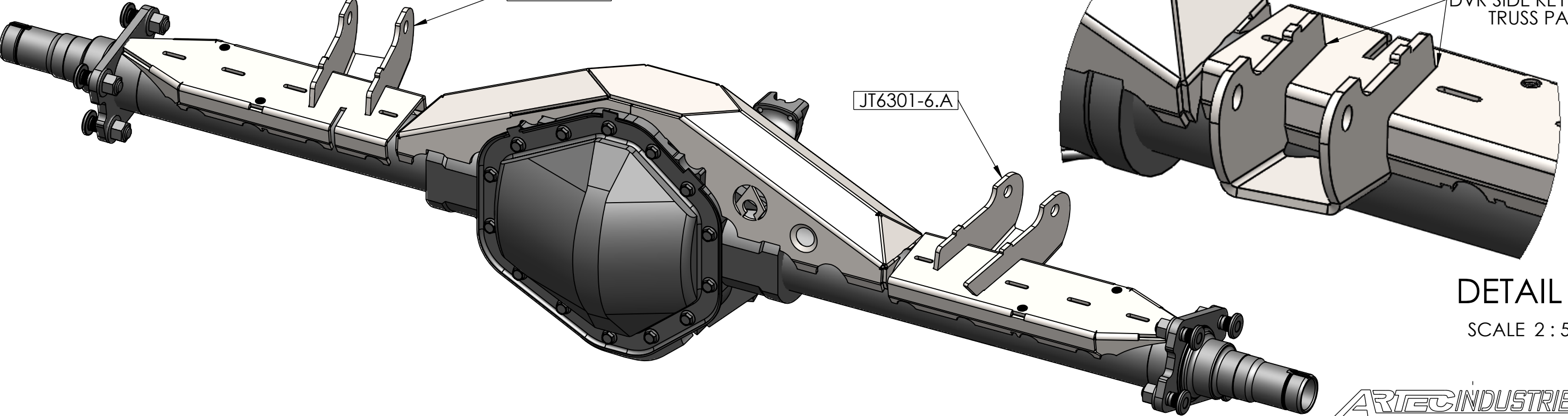

DETAIL B  
SCALE 2 : 5

4

3

2

1

4

3

2

1

**STEP 3: KEY / INSTALL, TAC & WELD INNER & OUTER TRACK BAR BRACKETs onto Dvr Truss Pad & Axle Housing.**

**\*NOTE: Ensure DVR Side Coil Pad "Keys" into Place Prior to Welding Inner Portion of Track Bar Brackets.\***

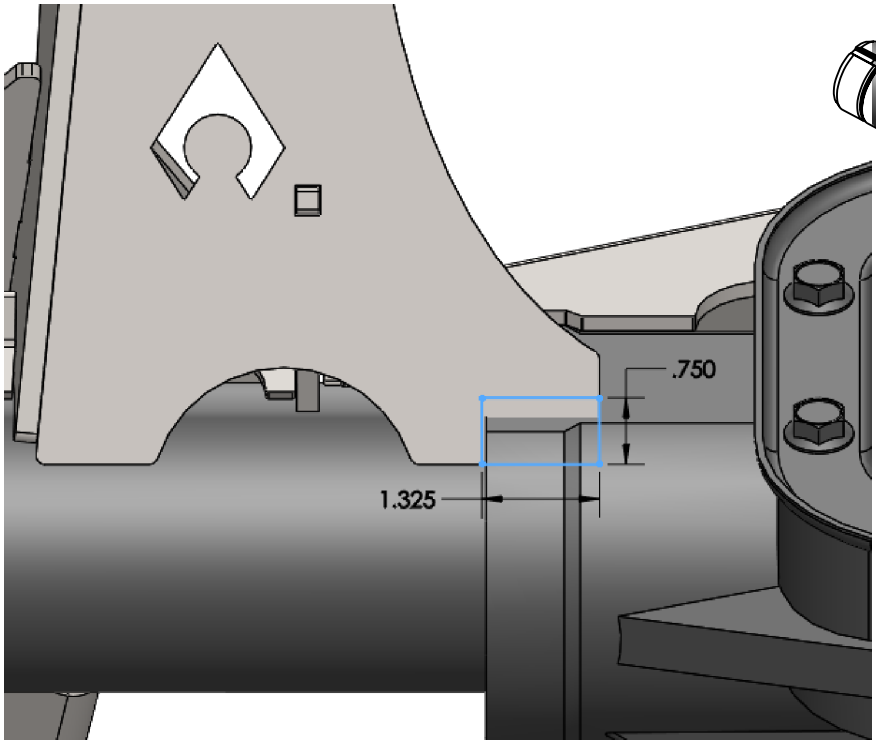

**GM 14 BOLT Requires Trimming  
Outer Track Bar Bracket**

B

B

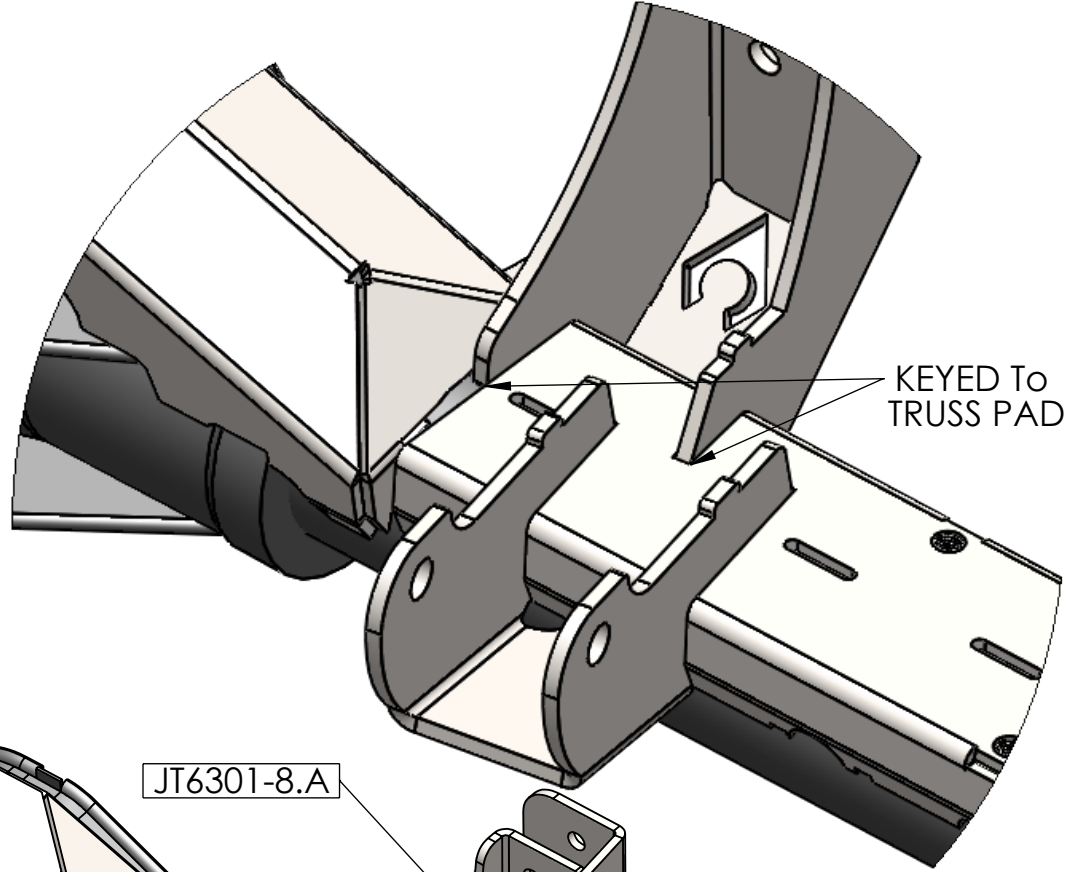

JT6301-8.A

**DETAIL C**  
SCALE 1 : 2.75

JT6301-7.A

C

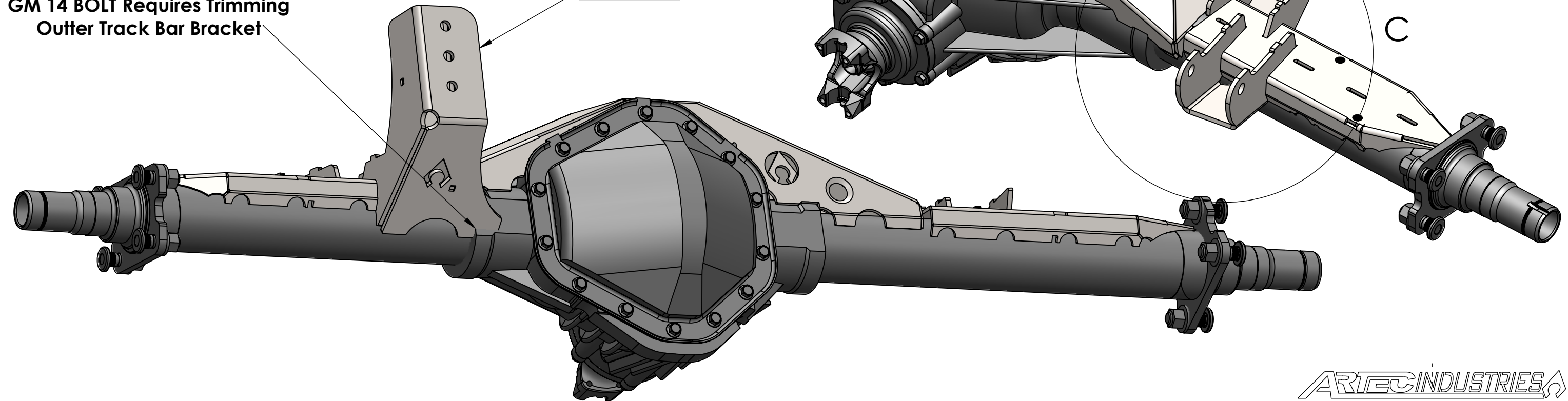

A

4

3

2

1

4

3

2

1

STEP 4: KEY / INSTALL & TAC DVR & PSG Coil PADS & Coil TUBEs.

DETAIL E  
SCALE 2:5

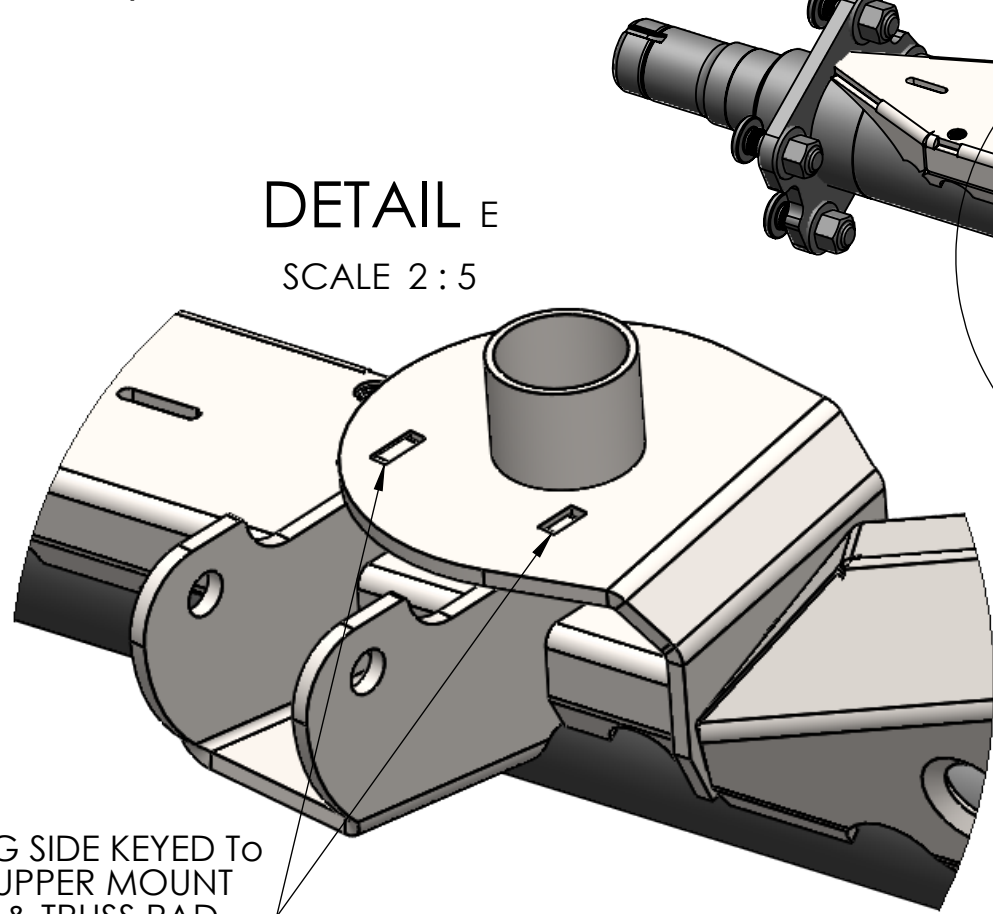

E

F

DETAIL F  
SCALE 2:5

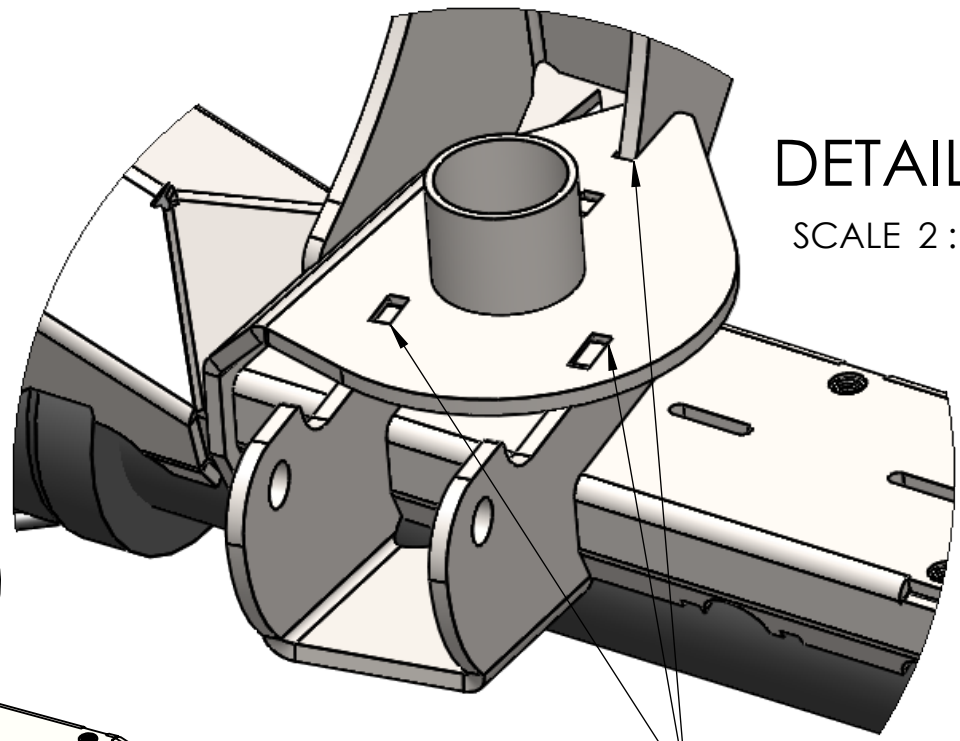

TU2002.A

JT6301-3.A

JT6301-4.A

TU2002.A

4

3

2

1

B

B

A

A

4

3

2

1

STEP 5: KEY / INSTALL & WELD DVR & PSG Lower Control Arm Brackets to TRUSS PAD

PSG SIDE KEYED TO UPPER MOUNT & TRUSS PAD

K

J

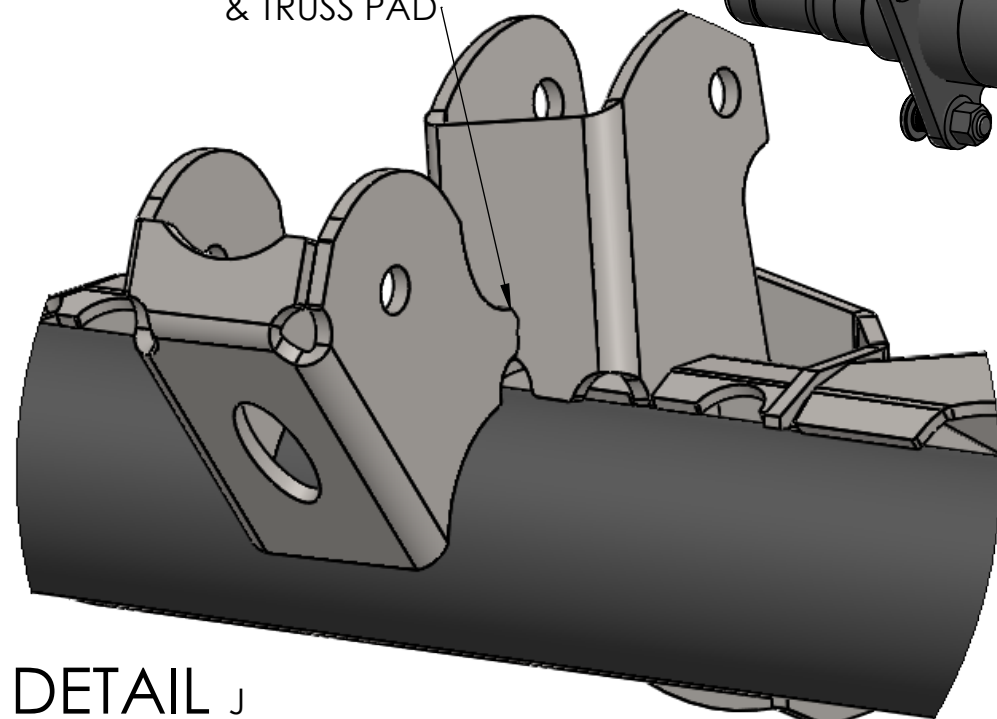

DETAIL J  
SCALE 2:5

JT6301-9.A

DVR SIDE KEYED TO UPPER MOUNT & TRUSS PAD

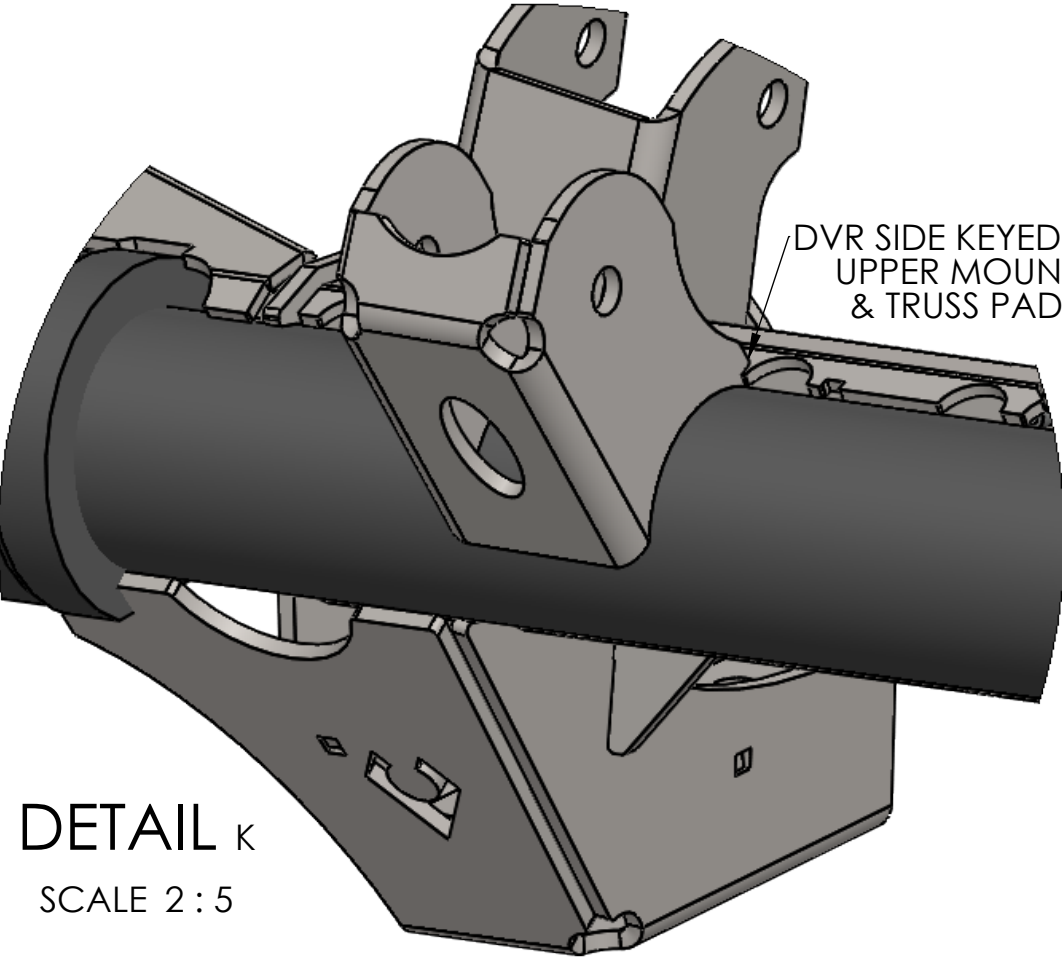

DETAIL K  
SCALE 2:5

JT6301-10.A

4

3

2

1

B

B

A

A

4

3

2

1

STEP 6: KEY / INSTALL & WELDED DVR & PSG Shock Mounts.

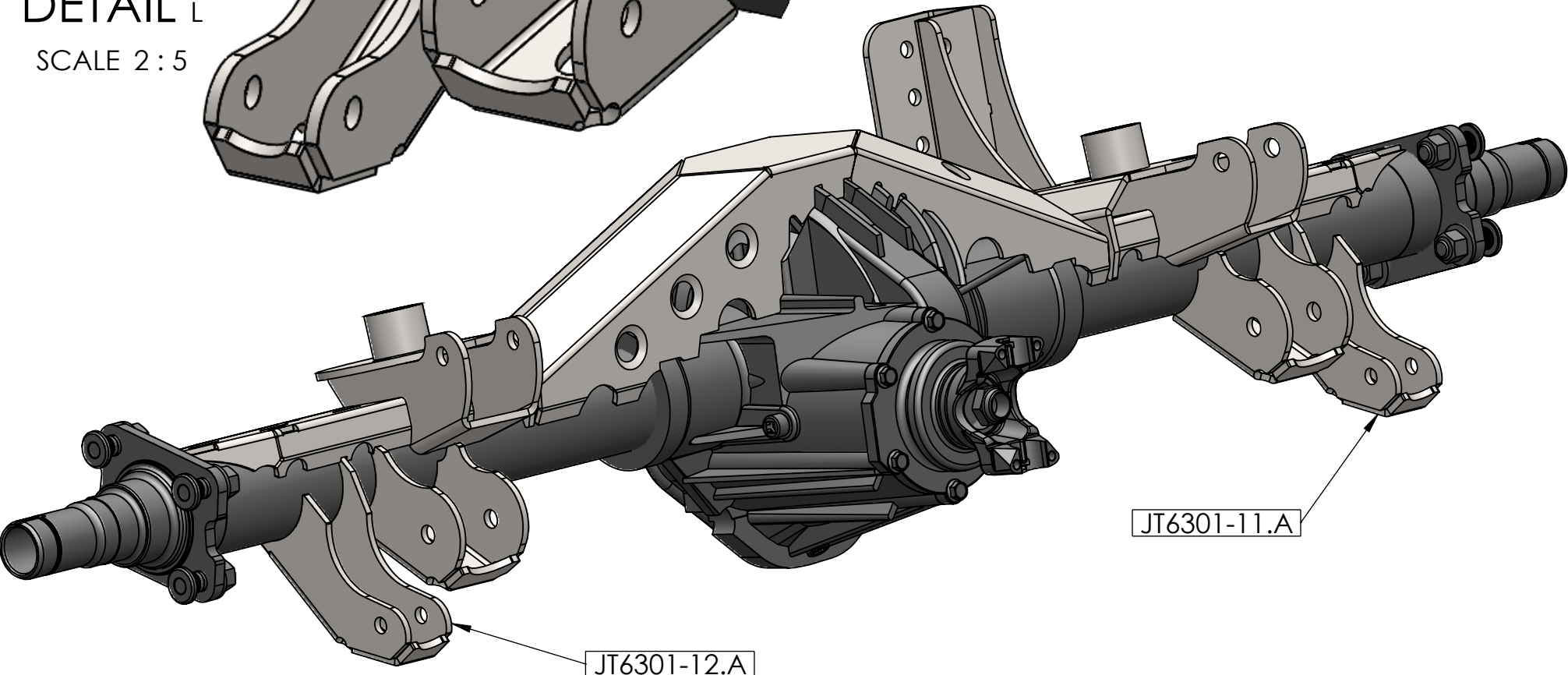
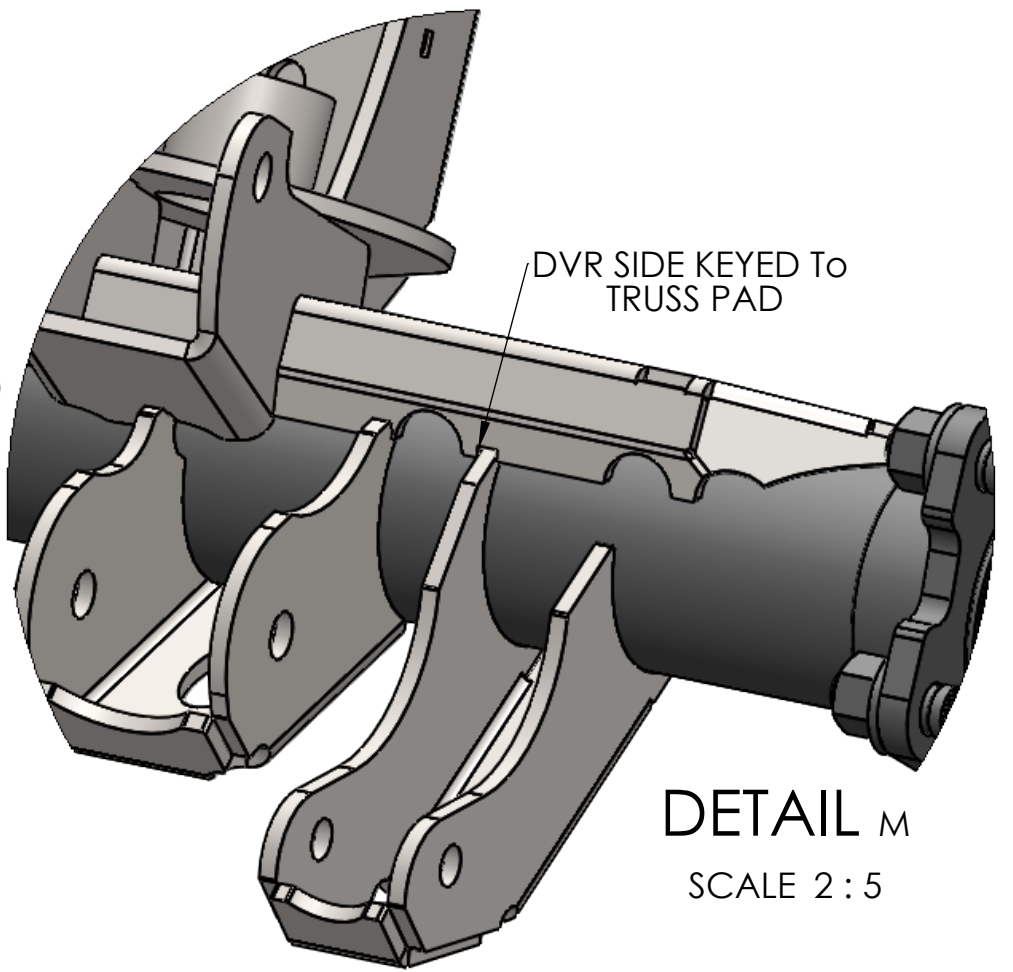
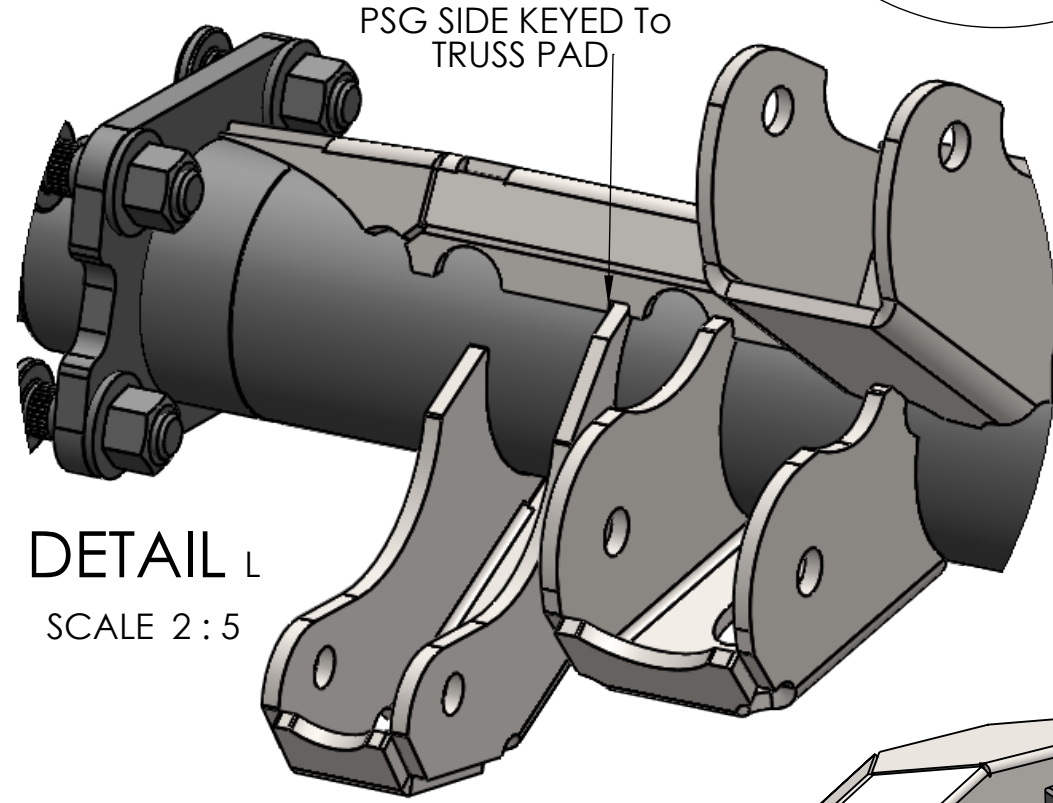
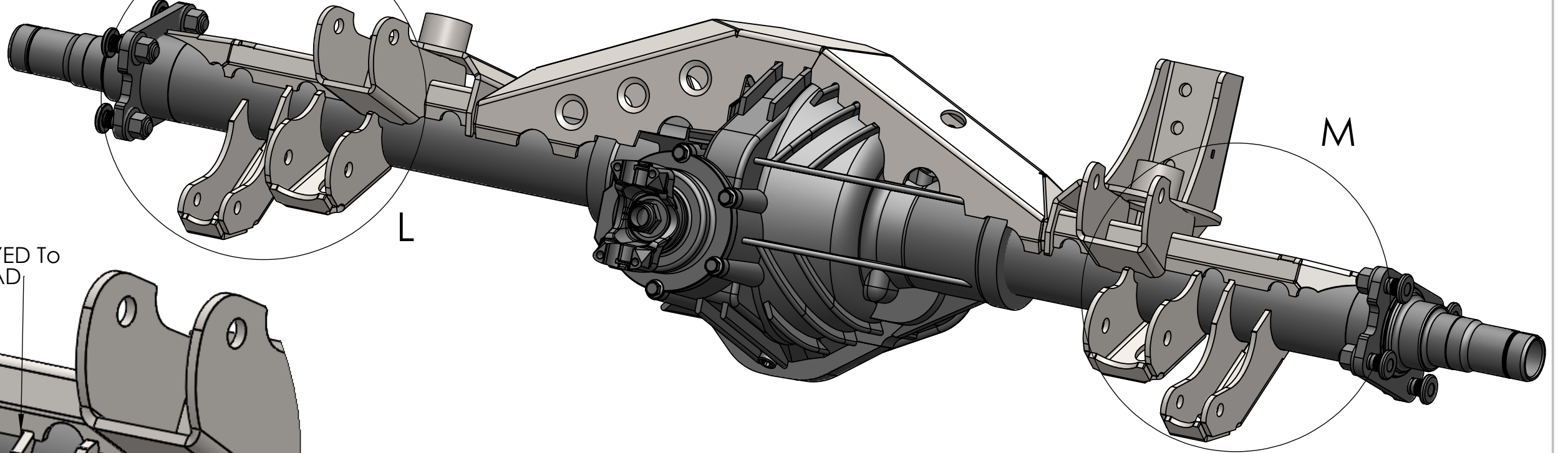

4

3

2

1

4

3

2

1

STEP 7: KEY / INSTALL & WELDED DVR & PSG SWAYBAR Mounts.

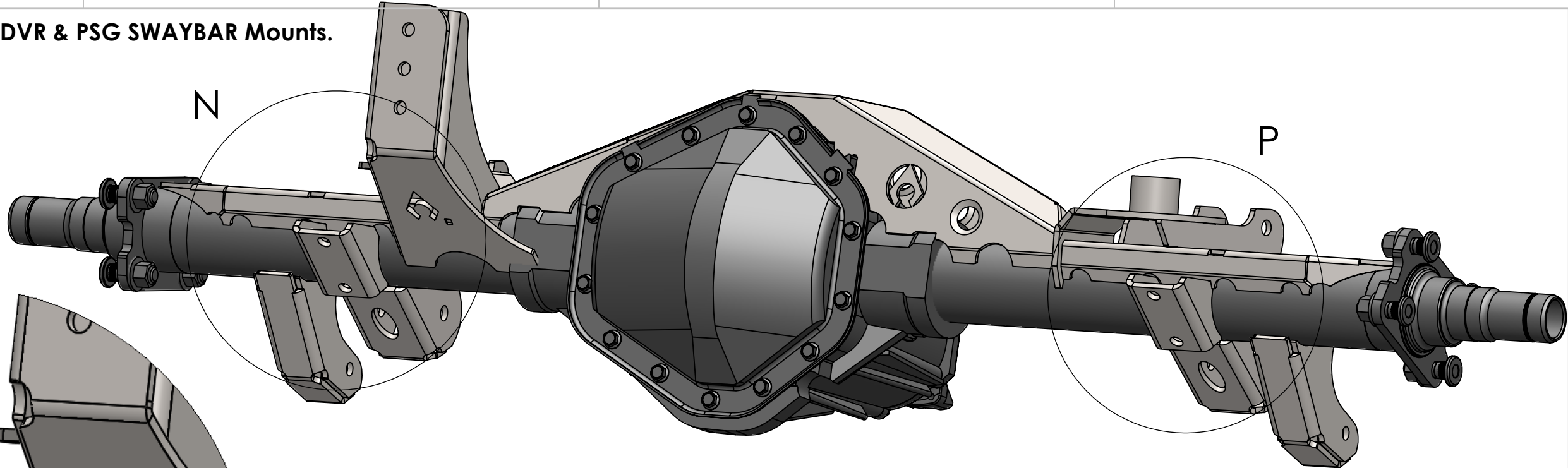

B

B

DVR SIDE KEYPED TO TRUSS PAD

PSG SIDE KEYPED TO TRUSS PAD

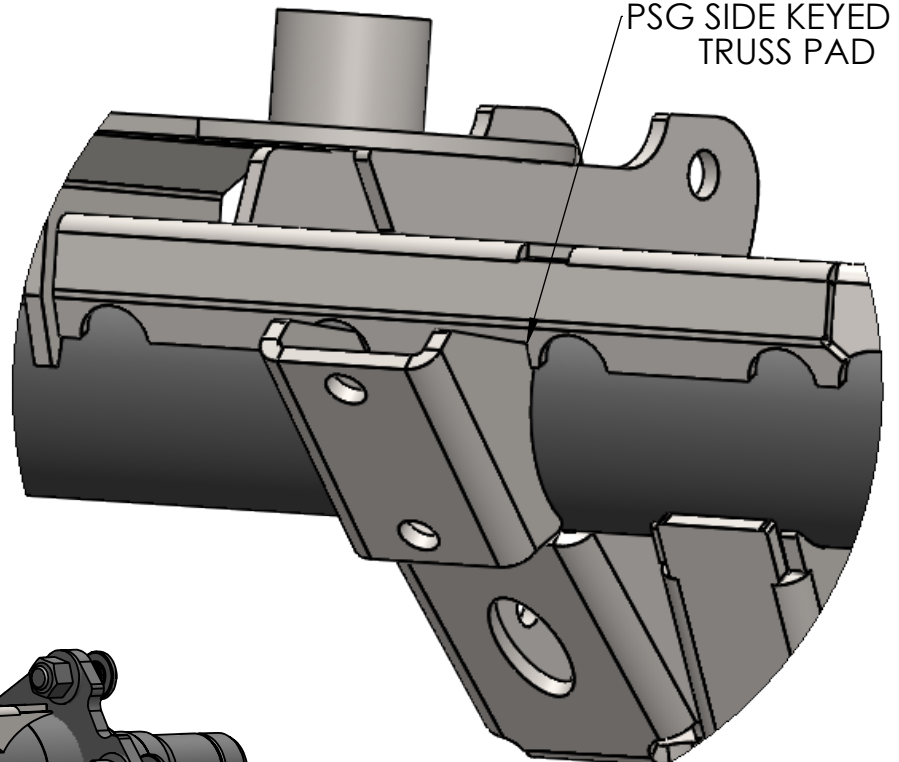
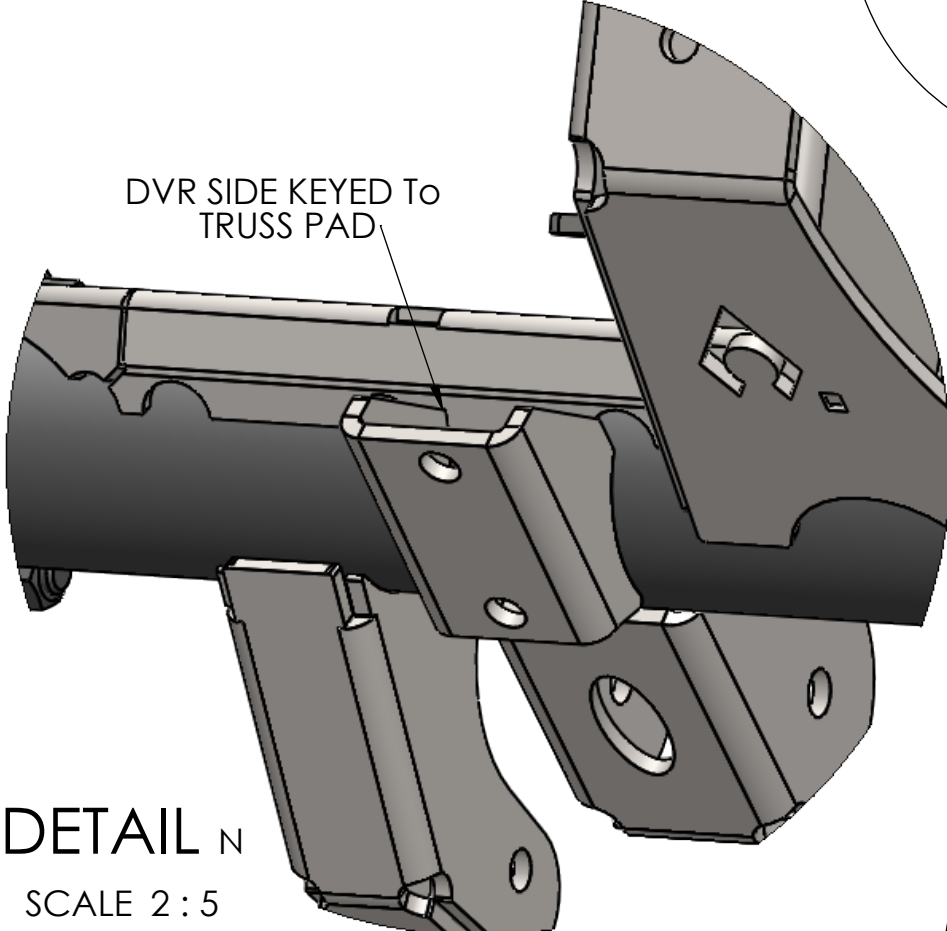

DETAIL N  
SCALE 2:5

DETAIL P  
SCALE 2:5

A

A

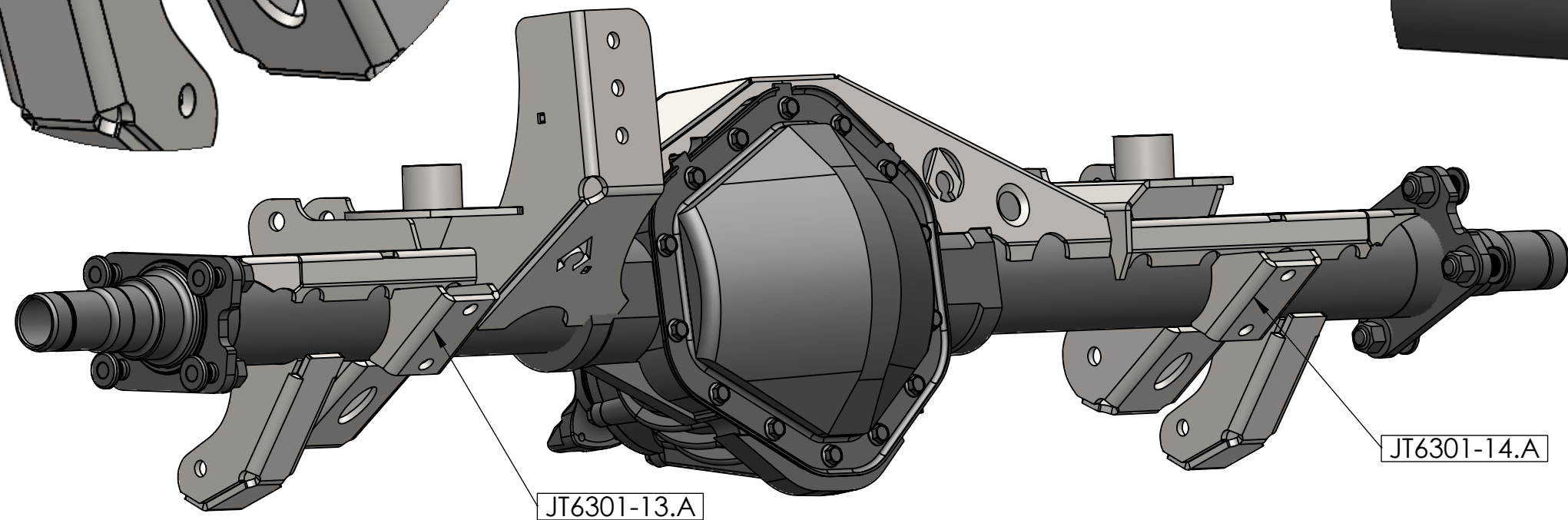

JT6301-14.A

JT6301-13.A

4

3

2

1

4

3

2

1

B

B

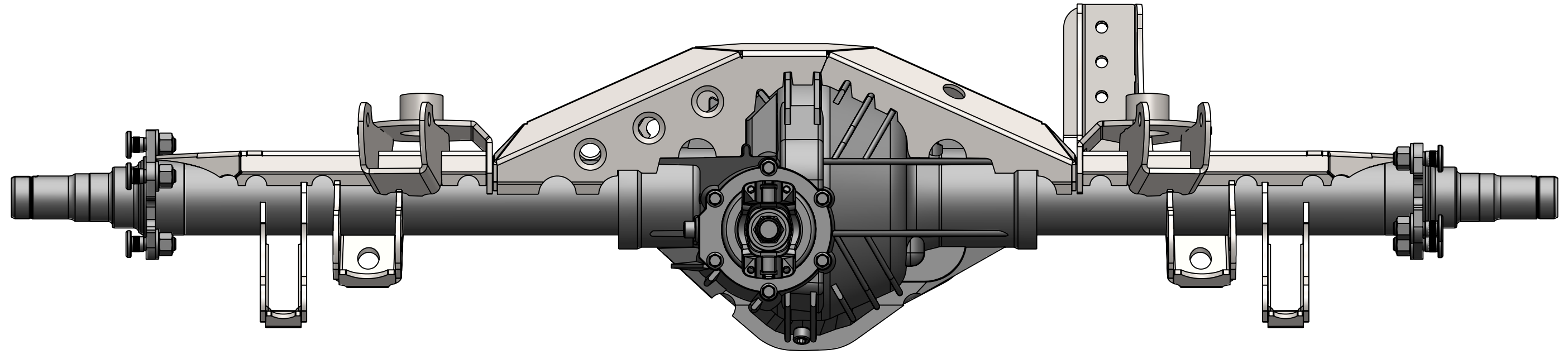

A

A

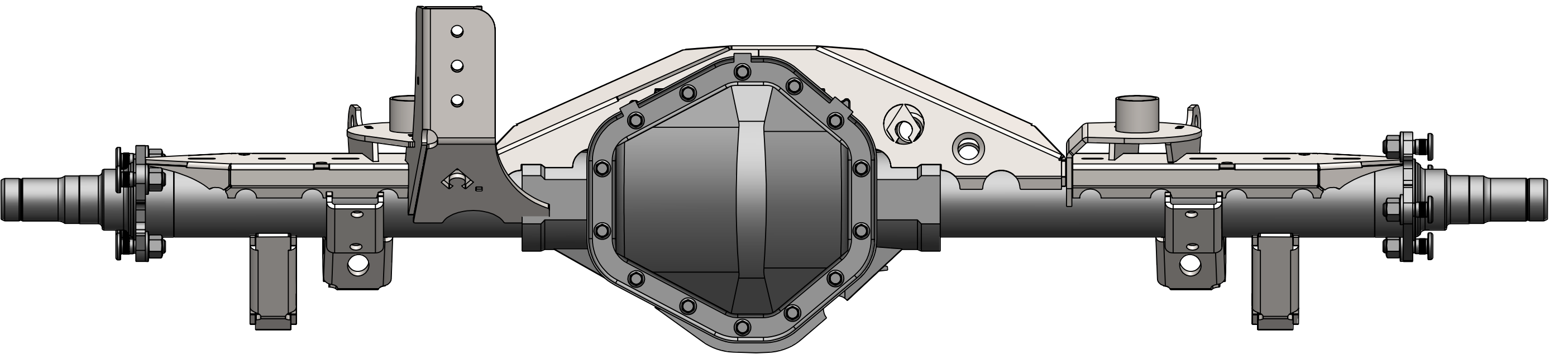

4

3

2

1

ARTEC INDUSTRIES

4

3

2

1

B

B

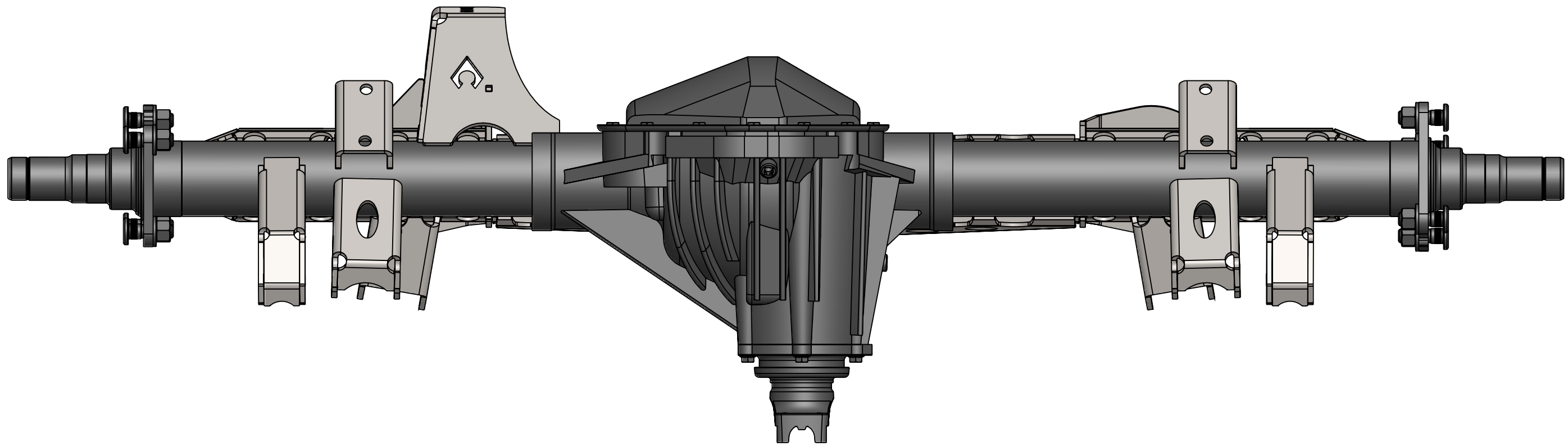

A

A

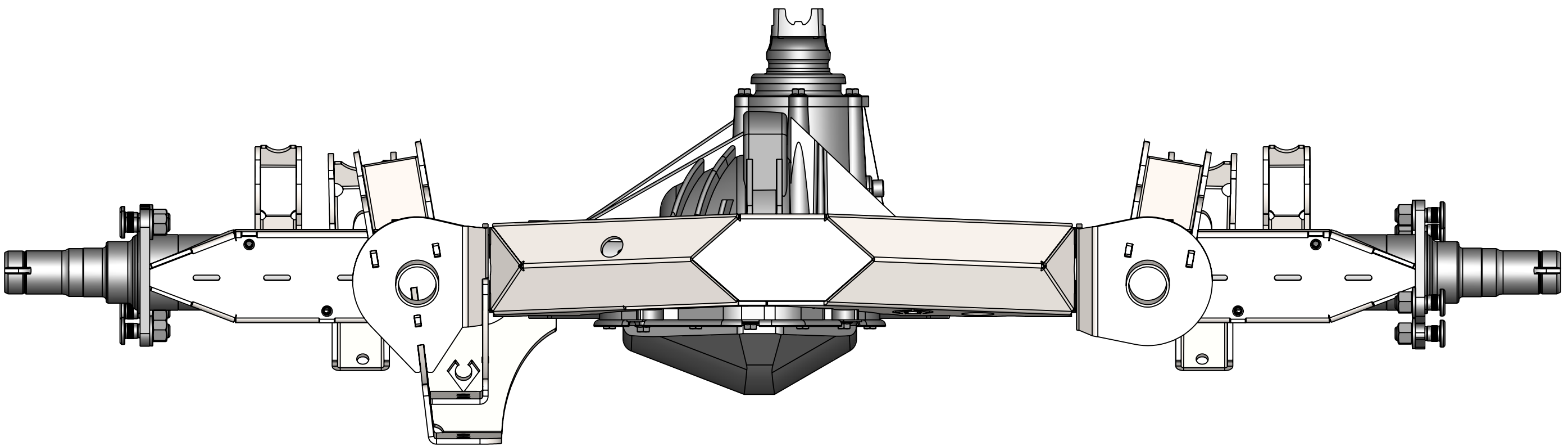

4

3

2

1

4

3

2

1

B

B

A

A

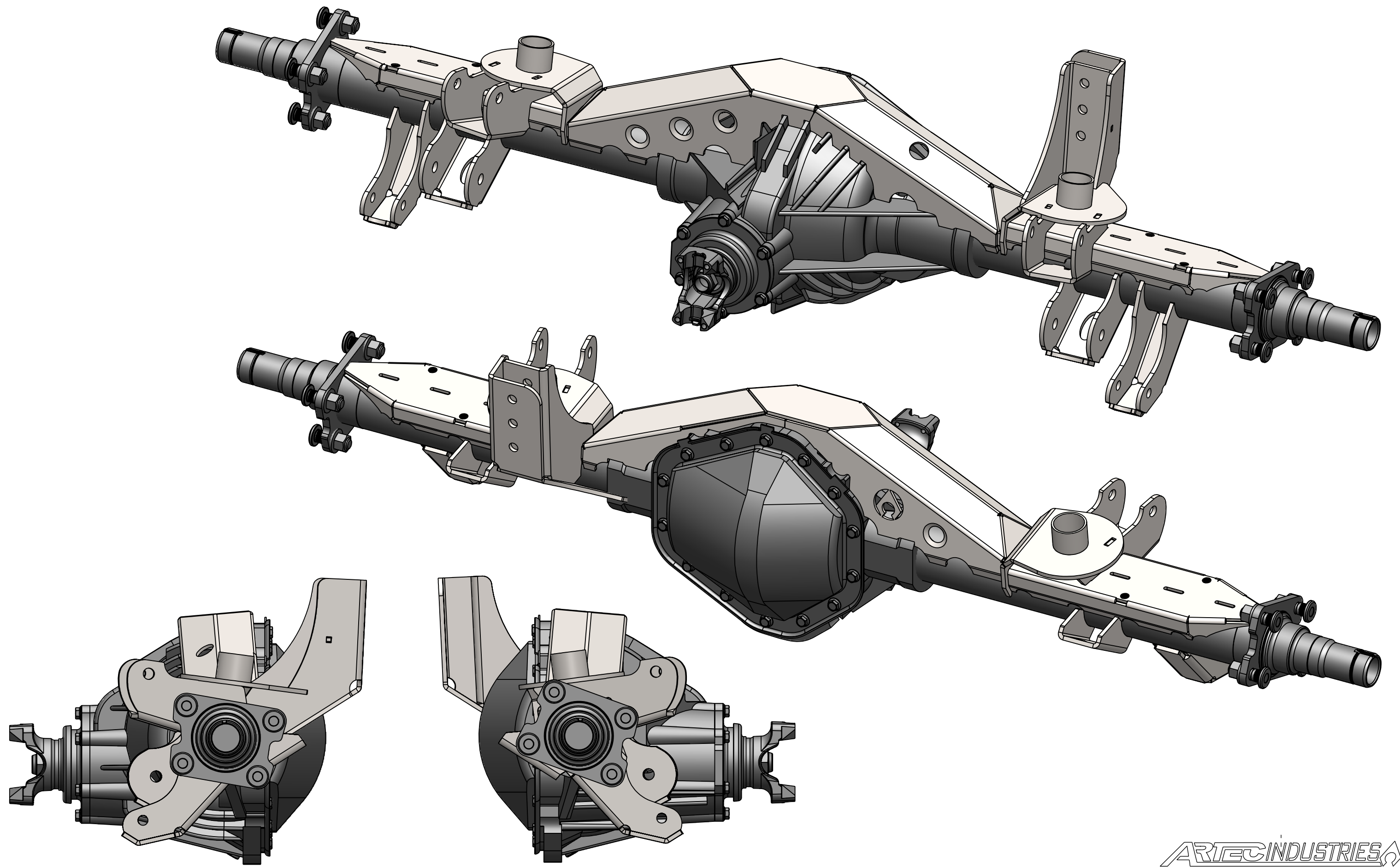

4

3

2

1